

# Stainless Steel Beaded Channels

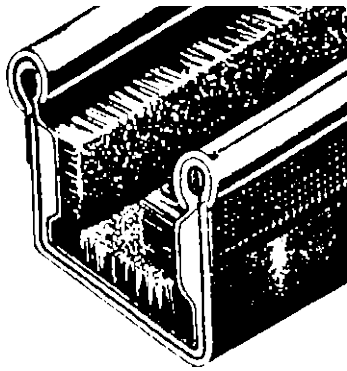

Stainless steel bead provides extra trim and increases side wall rigidity. Close packed wool pile fabric lining gives heavy cushion and weather tight fit with maximum friction to glass. Extra long life assured by galvanizing or super-thick, rubber covered steel core. Where used the rubber covered steel core gives utmost protection against corrosion, noise and rattles.

## Y528

Flexible Pile Lining  
Cloth Covered

All GM Cars 33-63  
Ford 52-58  
American Motors 48-60  
Many Others Mid 30'S-Mid 60'S  
Good Street Rod Channel  
Y528.....60" Length.....\$26.00  
Y528.....72" Length.....\$32.00  
Y528.....96" Length.....\$40.00  
Oversized Shipping Required on 49" and above  
Can be sold in 1/3 & 1/2 lengths

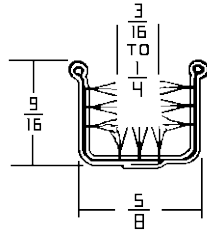

## Y630P

Flexible Poly-  
Propylene Pile  
Lining Rubber Covered

Narrow Channel  
Sometimes Used  
As A Division Bar 55-57 T-Bird  
Willys Mid 50'S  
Some Studebaker & Chrysler  
Suitable For Some Foreign Cars  
Replacement Channel For 60'S GM  
Y630P.....96" Length.....\$40.00  
Oversized Shipping Required on 49" and above  
Can be sold in 1/3 & 1/2 lengths

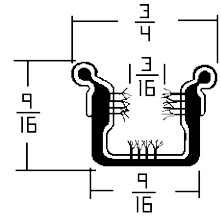

## Y526

Flexible Pile Lining  
Rubber Covered

Ford 52-56  
Chrysler Corp. 55-56  
American Motors 48-60  
Studebaker 53-62  
Willys 50-55  
Y526.....72" Length.....\$32.00  
Y526.....96" Length.....\$40.00  
Oversized Shipping Required on 49" and above  
Can be sold in 1/3 & 1/2 lengths

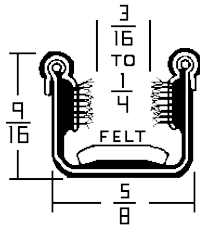

## Y620

Flexible Pile Lining  
Rubber Covered

Snap In Channel  
Ford, Merc., Edsel 57-64  
Studebaker 63  
Willys Truck 63

Discontinued, no longer available

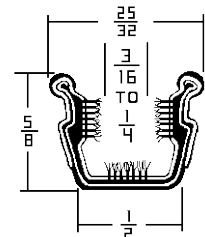

Please note:

The information supplied on channels, belt weatherstrips and division bars is taken from numerous manufactures catalogs and the accuracy cannot be assured. It is suggested that you check your existing channels for exact duplication. If you cannot find the channel that you need please send us a sample or a drawing and we will try to match it against our large stock.